

# next

## Bay Window Kit 666612 & 662382 Assembly instructions

**Notice:**

This kit is a bay window solution which converts a Next 25/28mm extendable straight curtain pole into a curtain pole suitable for a bay window. Please see [www.next.co.uk](http://www.next.co.uk) for a full range of 25-28mm extendable straight poles.

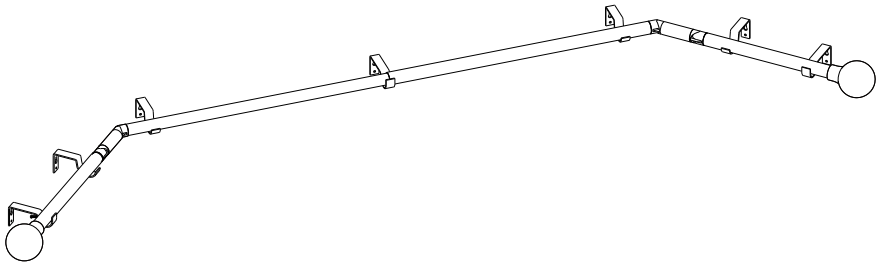

## Need Help?

With: Assembly instructions  
Missing or damaged parts

**CALL: 0333 777 8999**

**IMPORTANT — RETAIN FOR FUTURE REFERENCE**

## Before You Start

### Warnings

We suggest you retain these instructions for future reference.

This product should only be used on solid mounting at the point of fixing. This is necessary to take the weight of the curtain pole with curtain.

Please periodically check all fittings and re-tighten as necessary.

Unwrap all packaging materials and place the components on top of the carton box or on a clean floor to protect it from damage.

### Do's

We suggest you spend a short time reading through this leaflet before you start. When you are ready to start, make sure that you have the right tools and plenty of space.

Unwrap all packaging materials and place the components on a clean surface to protect it from damage.

Carefully check that you have all the parts before beginning assembly.

Due to the size of the product we recommend that it is assembled in the room intended for use.

Ensure the product is fully assembled as illustrated and all fixings are fully tightened before use.

Wipe occasionally with a soft cloth slightly dampened with water. Then buff with a dry clean soft cloth.

### Don'ts

We recommend cleaning with a soft dry cloth. Do not use abrasive materials as these will rub away the protective coating.

### Number of people required to assemble

One person who is competent with installation, however we do recommend that with two persons it should be easier to assemble this item.

### Time to assemble

About 2 hours.



### Tools required

Electric drill with 6mm masonry drill bit ; Cross head screwdriver

Spirit level and tape measure; Hack saw and small file

### Missing parts

If you are missing any fixtures and fittings for your product, please contact our customer service team on 0333 777 8999 and they will be happy to arrange for a replacement to be sent to you free of charge.

You can write to us at Home Customer Services

Next Retail Ltd,

Desford Road, Leicester, LE19 4AT

To View our full curtain pole range please visit [www.next.co.uk](http://www.next.co.uk)

## GETTING TO KNOW YOUR PRODUCT

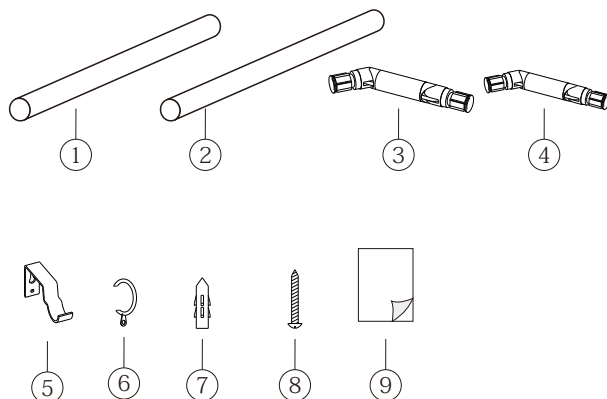

**Components supplied. Please use this guide if you require replacement parts.**

No	Description	Spec	Qty
1	Diam 28 pole	Diam 28 x 900mm	1
2	Diam 25 pole	Diam 25 x 900mm	1
3	Corner piece "A"	Fit 28mm pole	1
4	Corner piece "B"	Fit 25mm pole	1
5	Corner Bracket	Without fixed screw	4
6	Open end Ring	With cut-away section	20
7	Plastic plug		8
8	Fixing screws	L 38mm	8
9	Instructions	A4 x 2	1

## INTRODUCE 25/28MM EXTENDABLE STRAIGHT CURTAIN POLE (Sold Separately)

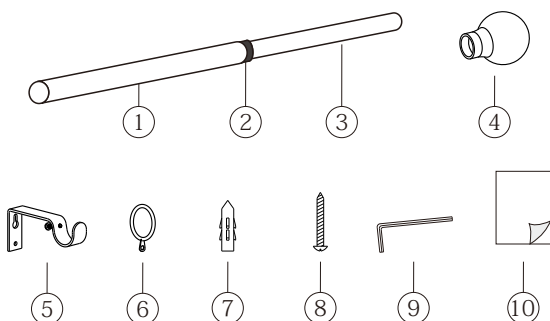

No.	Description	125-216cm Size		200-300cm Size		280-400cm Size	
		Spec	Qty	Spec	Qty	Spec	Qty
1	Outer pole	1150mm	1	1600mm	1	2100mm	1
2	Pole joint seal		1		1		1
3	Inner pole	1170mm	1	1620mm	1	2120mm	1
4	Finials		2		2		2
5	Bracket		3		3		3
6	Ring		20		30		40
7	Plastic plug		6		6		6
8	Fixing screws	L 38mm	6	L 38mm	6	L 38mm	6
9	Allen key	M4	1	M4	1	M4	1
10	Instructions	A4 x 2	1	A4 x 2	1	A4 x 2	1

#### Assembly Instructions

##### Step 1. Temporarily fit the brackets

1. Find the four corner brackets from bay window kit. These are the brackets which supplied with kit, Shown (A) in below figure.
2. Place one of the corner brackets (A) against the wall at the required height and 20cm from the corner of the recess. Make a mark on the wall at the top of the keyhole slot in the bracket. With the help of a spirit level, mark the wall for the remaining three corner brackets. Each bracket should be 20cm from the corner of the recess. At this stage, only mark the hole positions for the keyhole slots. (See Figure 1).

**\*IMPORTANT – Curtain rings will not run over brackets supplied with curtain poles. Please ensure that these are positioned correctly as shown below and where curtain will not need to be drawn.**

3. Find the 3 brackets from the straight curtain pole kit. These are the brackets which supplied with curtain pole. Shown 'B' in below figure.
4. In the same way, mark the desired hole positions for the keyhole slots of the 2 brackets at both end of window. It should be at least 8cm from the wall edge.
5. The remaining bracket should be positioned at the meeting point of the curtain on the front face of the window, usually the centre. This will also be the point at which the two parts of the extendable pole meet.
6. Drill 6mm holes in the wall at the seven bracket positions and insert plastic plugs.
7. Without the brackets being in position, screw in the screws in the plastic plugs. Occasionally try hanging a bracket from them until the brackets are starting to be held firmly.
8. Hang all the brackets on their screws.

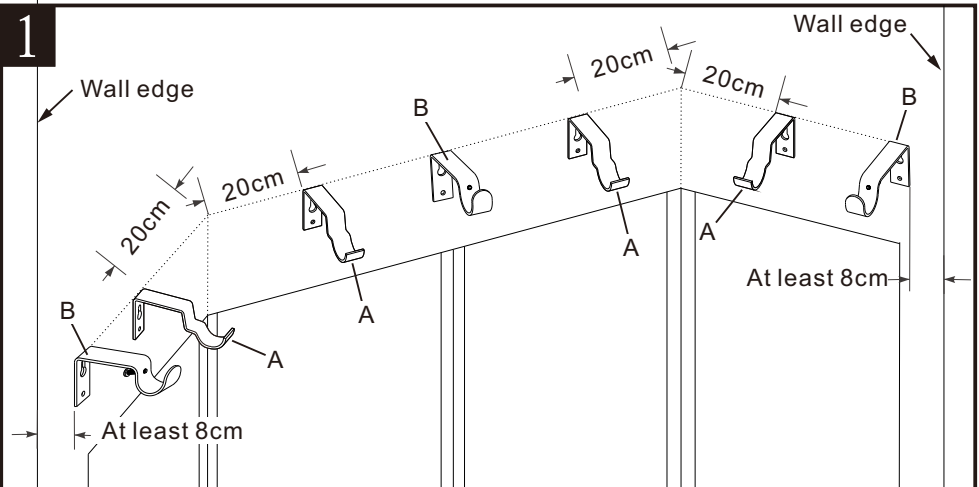

#### **Step 2. Try out the poles on the brackets and Permanently fix brackets**

1. Assemble the corner pieces (part no.s 3+4) together with the curtain poles from the desired extendable curtain pole following the diagram below. (See Figure 2.)
2. Rest the pole assembly on the brackets and check that the brackets are all in the correct place.
3. Now make any small adjustments to the height of the brackets by sliding them up or down their keyhole slots. Mark the position on the wall for the lower screws.
4. Remove the brackets and drill holes at the positions marked by above step.
5. Insert plastic plugs and re-position the brackets. Tighten the keyhole slot screws as much as possible whilst being able to slide the brackets into place.
6. Insert screws in the lower bracket holes and tighten fully.

#### **Step 3. Cut the poles to length**

Note that the join of the extendable pole should be located aligned with the centre bracket (B). This will prevent the curtain rings catching on the pole joint.

1. With the poles resting on the brackets measure from the join on the main poles to the centre of the middle bracket (B). Note measurement.
2. Remove poles from brackets and separate the two main pole sections.
3. Measure and mark the distance noted above in step 1 onto outer 28mm pole (only)
4. Remove plastic pole joint seal.
5. Cut the pole using a hacksaw and remove any burrs with a file.
6. Re-insert plastic pole joint seal.
7. Trim poles supplied with bay window kit to desired length with a hacksaw.
8. Remove protective film and re-assemble curtain poles and re-check positioning on

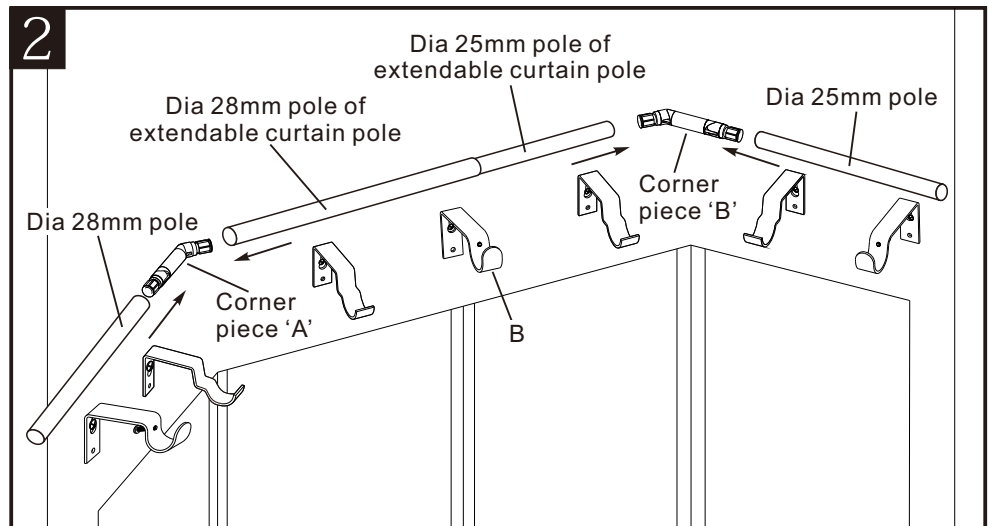

### **Step 4. Fit the rings**

1. Slide sufficient rings onto the pole. We recommend one ring for every 10cm of pole. (See Figure 3.)  
The rings supplied with the bay window kit have a cut-away section that allows them to pass over the corner brackets (A). These should be used for any part of the curtain that needs to travel around the bay corner.
2. We advise using complete curtain rings supplied with the extendable pole for parts of the curtain that do not need to pass around the corner.
3. Keep two complete rings aside for the pole ends.
4. Rest the pole assembly on the brackets
5. Slide a ring onto each end of the pole to hold the end of the curtain in place.

### **Step 5. Finishing off**

1. Secure the pole to the three brackets that have fixing screws by tightening the screws against the pole. (See Figure 4.)
2. Secure the finials to each end of the pole using the Allen key provided to tighten the grub screws. (See Figure 5.)
3. The pole is now ready to accept curtains by slipping the curtain hooks through the eyelets on the rings. We recommend one ring for every 10cm of pole.
4. Hang the curtain on the curtain rings.

3

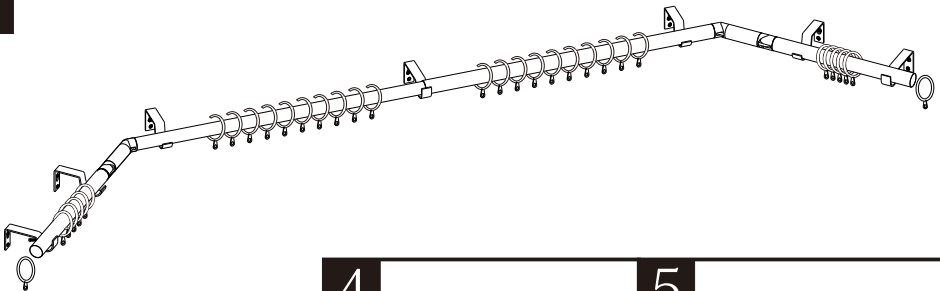

4

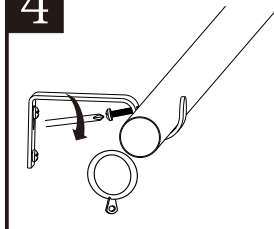

5

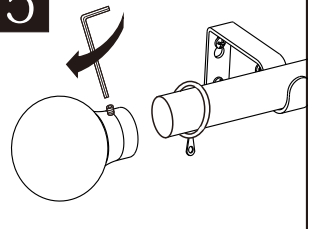

**Actual product size**

See below diagram

Unit: mm

