

# BEFORE YOU GET STARTED...

*We're confident you'll love your gorgeous new Next furniture. However, it's worth making absolutely certain before you put it all together.*

*So, let's quickly run through these three steps:*

## 1. COLOUR

Make sure you're happy with the colour  
No need to unpack everything, just check the first component.

## 2. PROTECTIVE PACKAGING

If you're happy, then it's time to get opening! Start by laying everything out on the protective packaging – this will prevent anything getting scratched.

## 3. PARTS PAGE

Finally, double check you have all the pieces by referencing the parts page of the instructions.

## TIPS FOR RETURNS

Not completely happy with the product? No problem. We just need everything back in the original packaging, so follow the steps below and this will ensure a super-smooth returns process and no delay to your refund.

DO



- Check everything is there (the 'parts page' is a handy checklist).
- Pop all the loose fittings and fixtures into the packaging provided or tie them up in a plastic bag.
- Wrap all the big components back up in the original protective packaging.
- Close up the box and seal it securely (don't be afraid to use plenty of tape).

DON'T



- Leave anything assembled - all components should be dismantled and separately packed.
- Put loose fixtures and fittings straight into the box.
- Throw it back in the box carelessly – as it may get damaged.

next  
HOME

Then just give us a call on 0333 777 8999 and we'll sort out a pick up time for you.

**next**

## CUBE

671905,675290,173302

Assembly instructions

**Actual product size**

H71/80 x W58x D58 cm

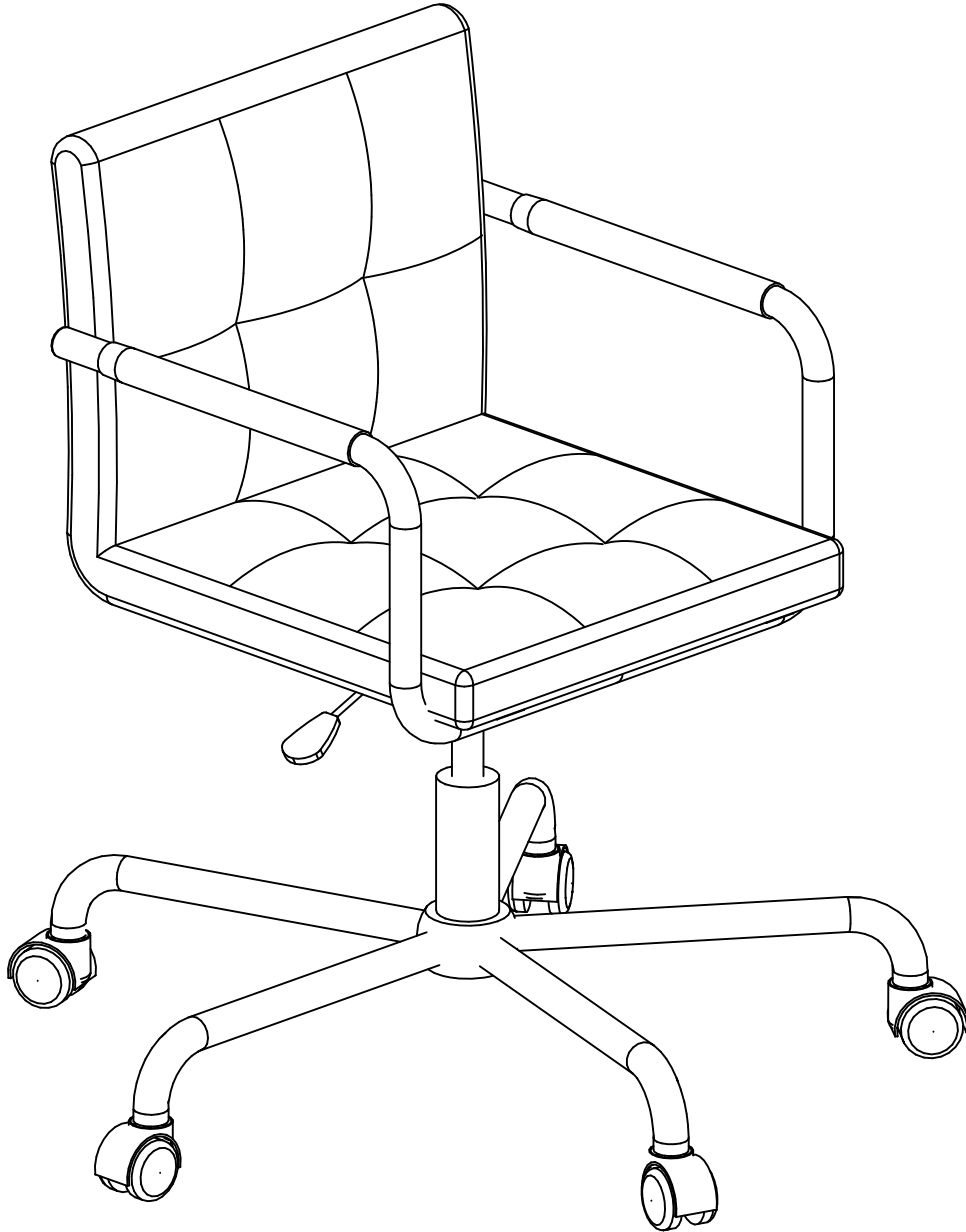

25025 / 018 Rev 4

### **Need Help?**

With: Assembly instructions  
Missing or damaged parts

**CALL: 0333 777 8999**

**IMPORTANT – RETAIN FOR FUTURE REFERENCE**

## BEFORE YOU START

### Warnings

We suggest you retain these instructions for future reference. Keep fittings out of children's reach and keep children well away from construction area.

This product should only be used on firm level ground.

Please periodically check all fittings and re-tighten as necessary. Avoid exposing the furniture to excessive heat or direct sunlight as this can cause cracking of the wood and deterioration of the colour. Unwrap all packaging materials and place the components on top of the carton box or on a clean floor to protect it from damage.

### Do's

We suggest you spend a short time reading through this leaflet before you start.

When you are ready to start, make sure that you have the right tools and plenty of space.

Unwrap all packaging materials and place the components on a clean surface to protect it from damage. We recommend that the packaging is used to protect the surfaces during assembly.

Carefully check that you have all the parts before beginning assembly.

Ensure the product is fully assembled as illustrated and all fixings fully tightened before use. Check fixings regularly to ensure they remain tight.

Always wipe dry after cleaning.

To clean your item, please lightly brush clean or lightly wipe with a slightly dampened cloth.

Keep away from strong heat sources.

Occasional overall cleaning should be carried out approximately once a month by using a slightly dampened soft cloth. Then buff with a dry clean soft cloth.

### Don'ts

Never allow any kind of liquid to remain on your furniture. Do not stand or lean back on your chairs.

### Composition of the Cover:

-5% Cotton

-65% Polyurethane

-30% Polyester

### Number of people required to assemble

One person is required to assemble this item.

### Time to assemble

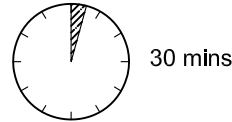

### Tools required

### Missing parts

If you are missing any fixtures and fittings for your product, please contact our customer service team on 0333 777 8999 and they will be happy to arrange for a replacement to be sent to you free of charge.

### Home service technicians

If you have a fault with your product please contact our customer service team on 0333 777 8999. If you have had the product for 28 days or less, you may be offered a replacement, refund or for a fully trained home service technician to visit your home to assess the fault and repair the product where possible. If you have had the product for more than 28 days we will send an independent home service technician to review and repair the product where possible and recommend further action.

### You can write to us at

Home Customer Services  
Next Retail Ltd,  
Desford Road,  
Leicester,  
LE19 4AT

To View our full furniture range please visit [www.next.co.uk](http://www.next.co.uk)

## GETTING TO KNOW YOUR PRODUCT

Components supplied. Please use this guide if you require replacement parts.

ID nr. XXXX

Ref	Dimensions	Qty	Ctn
1	500x470x360 mm	1	1
2	Ø165x275x60 mm	1	1
3	Ø50x340 mm	1	1
4	Ø640x100 mm	1	1
5	50x50x65 mm	3	1
6	50x50x65 mm	2	1

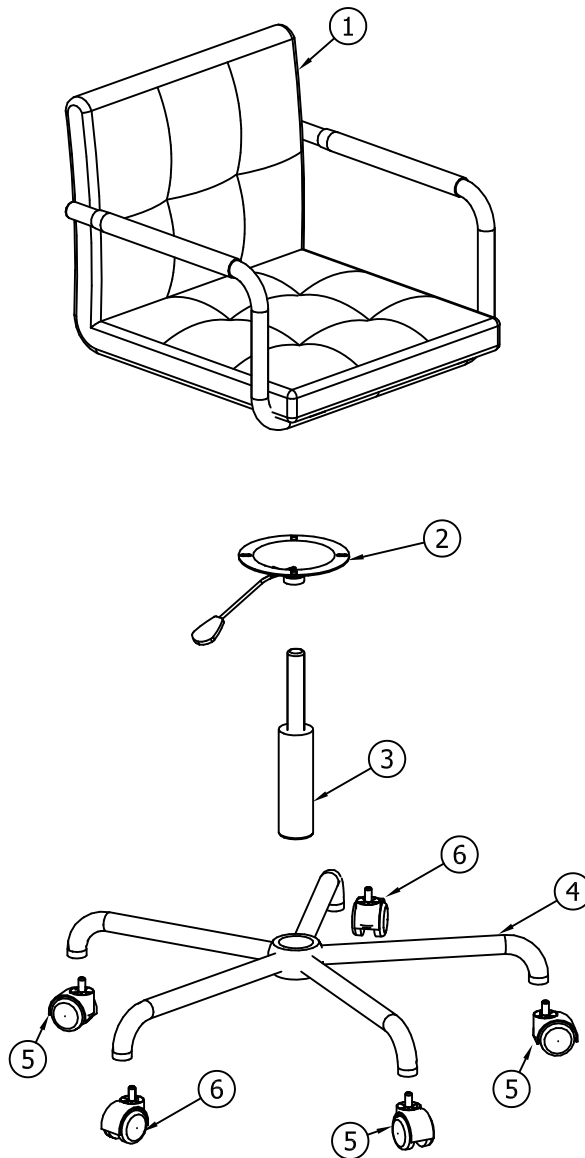

**Fixtures and fittings supplied (actual size)**

Ref	Dimensions	Qty
A	M6x18 mm	4
B	M6/Ø16 mm	4
C	M6	4

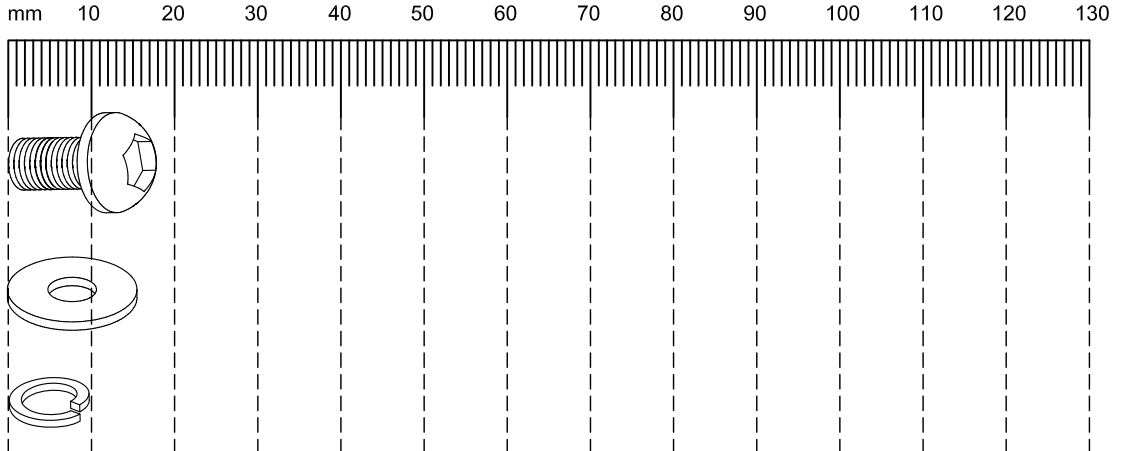

**Fixtures and fittings supplied (not to scale)**

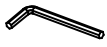
Ref	Dimensions	Visual	Qty
D	5 mm		1

1

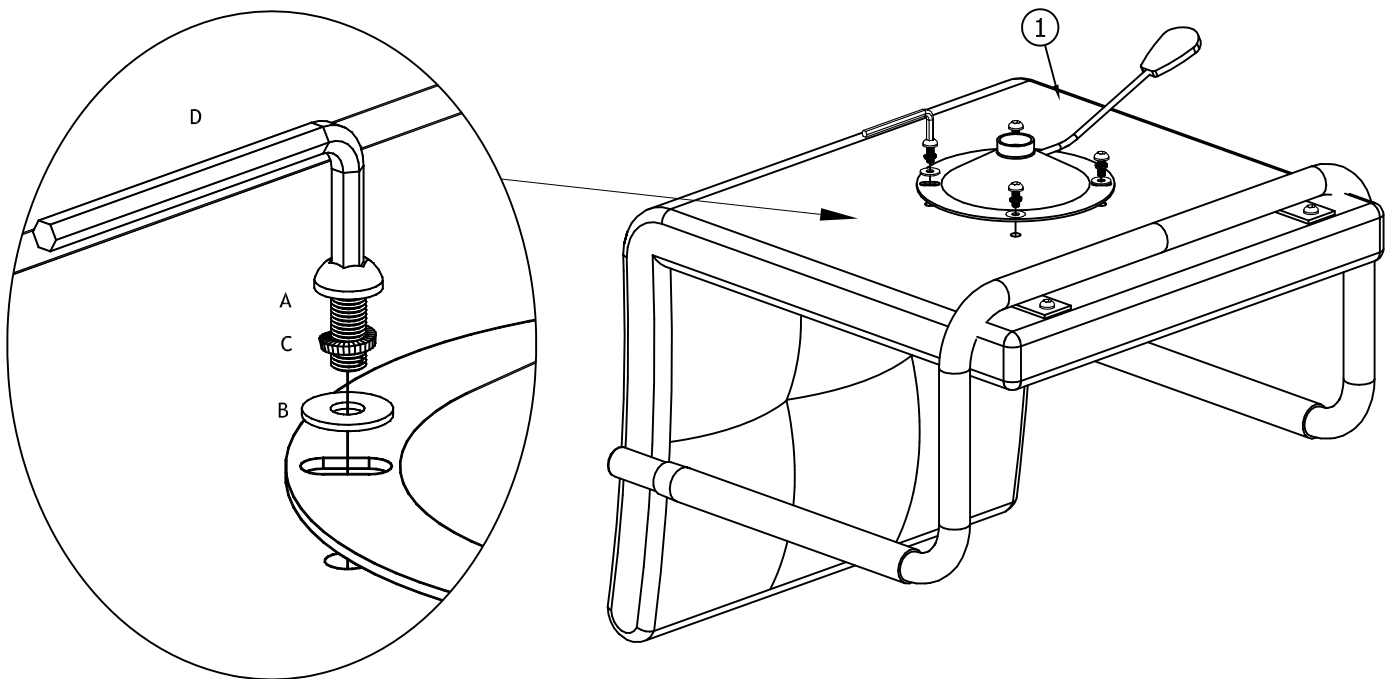
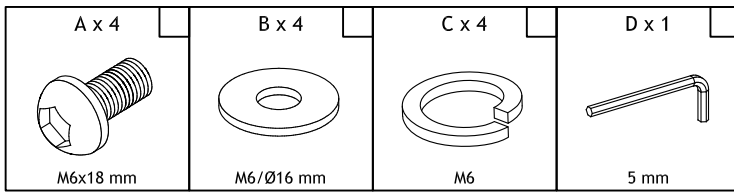

2

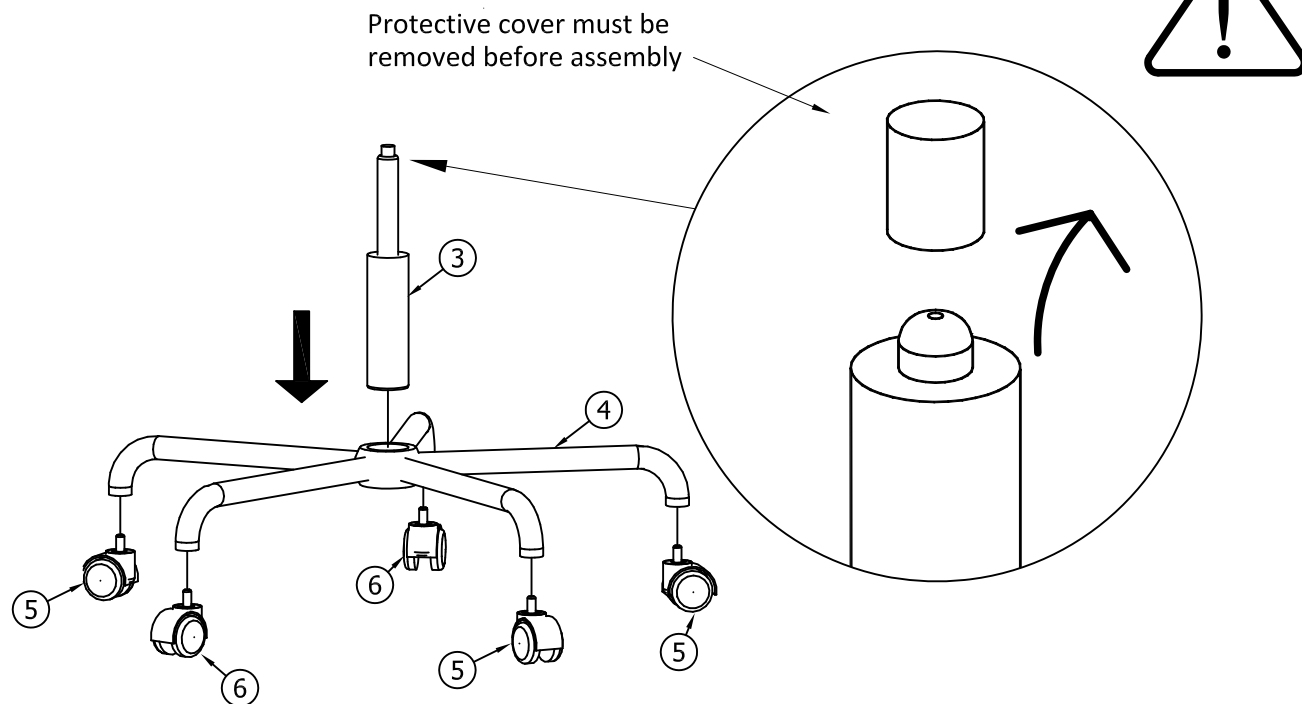

UK: For safety reasons the castor lock automatically when the chair is not in use.

3

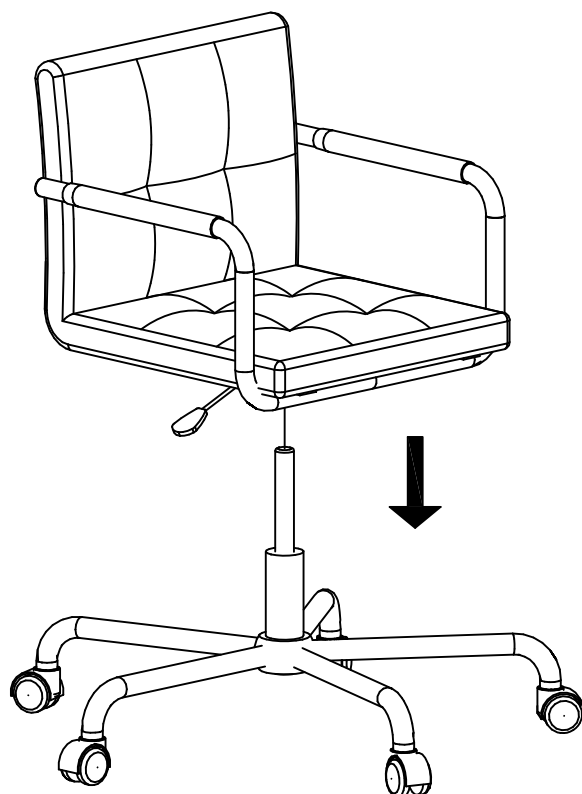

4

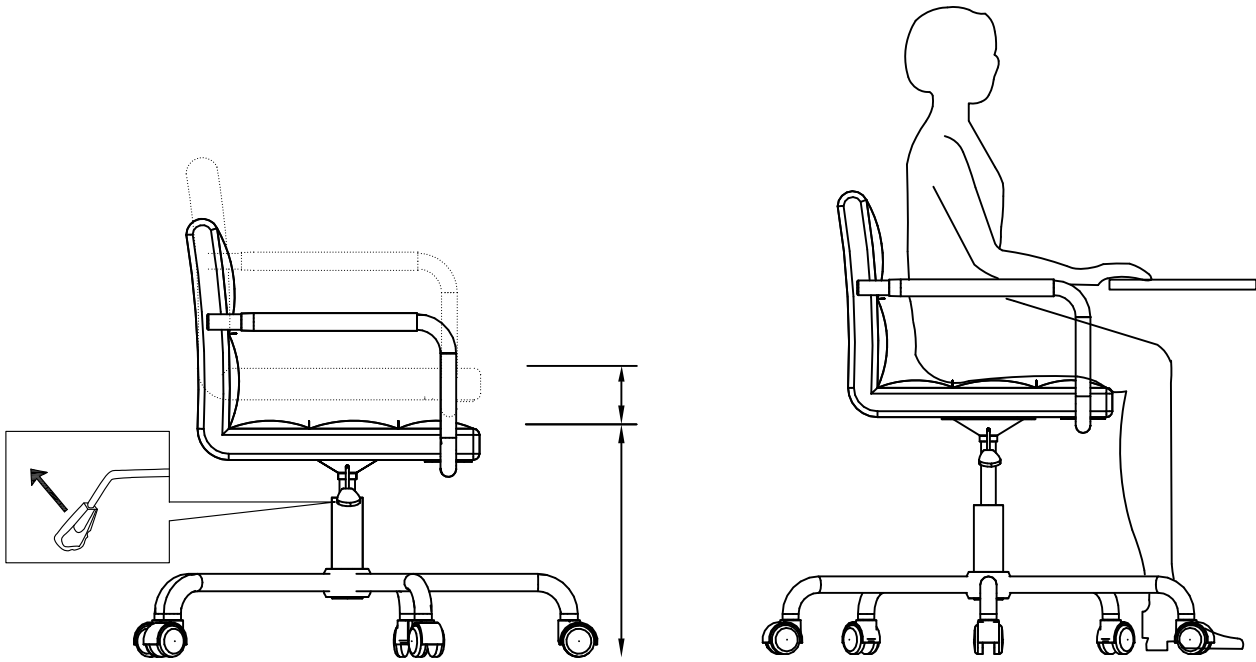

UK: Use the lever on right hand side under the seat to adjust the high of the seat by pressing the lever up wards.

5

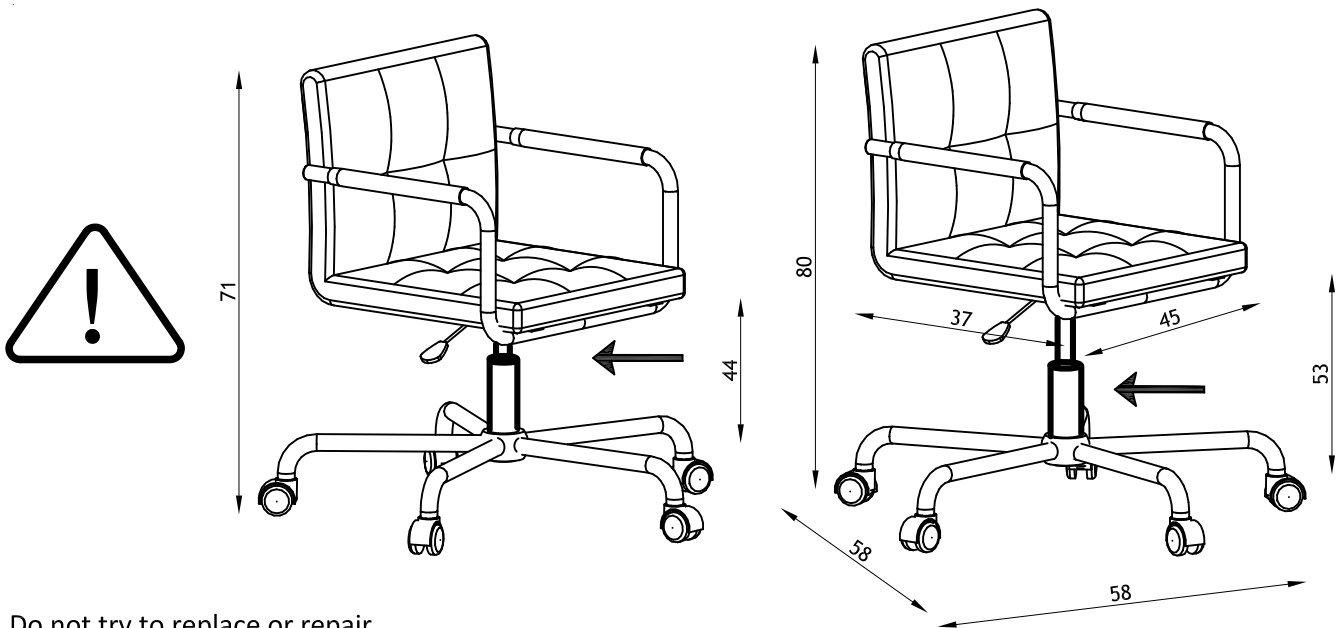

UK: Do not try to replace or repair

UK: Use this product only for seating one person at a time.

This chair is intended to be used on hard floors. We always recommend that the chair is placed on a protective floor plate

UK: This office chair is not intended for use in offices and institutions. This office chair is for private use only

UK: Office chair type A