

## ASSEMBLY INSTRUCTIONS.

**IMPORTANT - RETAIN FOR FUTURE REFERENCE - READ CAREFULLY.**

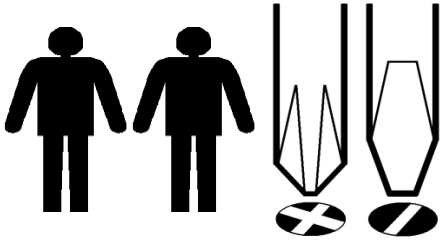

**Helpline**

If you have any problems with this product or require any replacement fittings please contact Customer Services Tel: 0333 777 8999

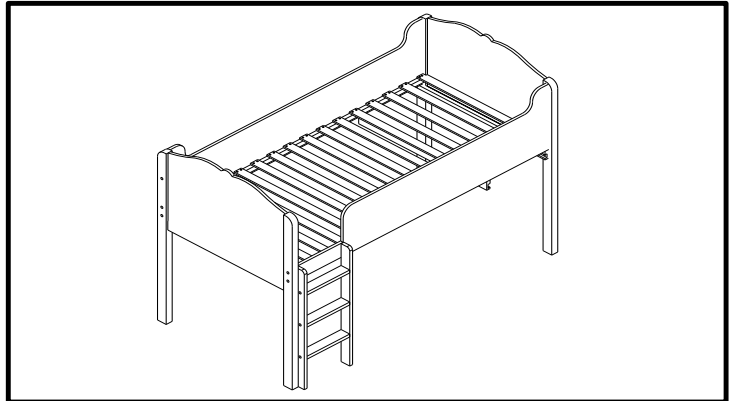

Regrettably self assembly items cannot be returned once assembly is part or fully completed unless the item is found to be faulty. Should you need to return the unassembled product, please repack in the original packaging.

## IMPORTANT

- We suggest you spend a short time reading through this leaflet and then follow the simple step-by-step instructions.
- Carefully check that you have all parts before beginning assembly.
- Keep fittings out of children's reach and keep children well away from the construction area.
- We recommend that the packaging is used to protect the surfaces during assembly.
- A minimum of 2 persons is required to assemble this product.
- **WARNING:** Children can become trapped between the bed and the wall. To avoid risk of serious injury the distance between the top safety barrier and the wall shall not exceed 75mm or shall be more than 230mm.
- **WARNING:** Do not place this child's bed near heat sources, windows and other furniture.
- **WARNING:** Do not use this child's bed if any part is broken, torn or missing.
- Ensure not to leave items such as ropes, strings, cords, harnesses and belts attached to or hung to the bunk/high bed due to the risk of strangulation.
- Do not use this item if any structural part is broken or missing.
- High beds and the upper bed of bunk beds are not suitable for children under six years due to risk of injury from falls.
- Children are likely to play, bounce, jump and climb on beds, therefore the child's bed should not be placed too close to other furniture or windows, and should be placed either tight to any wall or have a gap of 300mm between the wall and the side of the bed.
- The cot shall no longer be used once the child is able to climb out in order to prevent injury from falling.
- All assembly fittings shall always be tightened properly. Screws shall not be loose because a child can squeeze parts of the body, or clothing (e.g. strings, necklaces, ribbons for babies, dummies, etc.) could get caught. There would be danger of strangulation.

## PRODUCT INFORMATION

- Made from MDF with a painted finish.
- Made in China.
- A mark is present on the bed to show the maximum height of the mattress to be used.
- This child's bed is recommended for use by children aged 6 and upwards.
- A mattress measuring 90cm x 190cm is intended for use with this child's bed.
- BS EN 747-1:2007

## CARE INSTRUCTIONS

- For general cleaning, periodically dust with a soft cloth.
- Do not rub or scrub the surface when cleaning.
- Always use a non-silicone based furniture polish. Silicone in furniture polishes can break down the lacquer finish.
- Any spills should be removed immediately with a soft clean damp cloth and dried immediately.
- Ensure the product is protected with mats and coasters when items are placed on the surfaces, to prevent scratching or damage.
- Do not put hot dishes directly on the surfaces of the item.
- Avoid keeping furniture in direct sunlight or close to any heat sources as this can cause cracking, discolouration or warping.
- Never drag pieces of furniture across the floor as this will cause damage to the joints.
- All assembly fixings should always be tightened properly and periodically check all fixings and tighten if necessary.

## FITTINGS

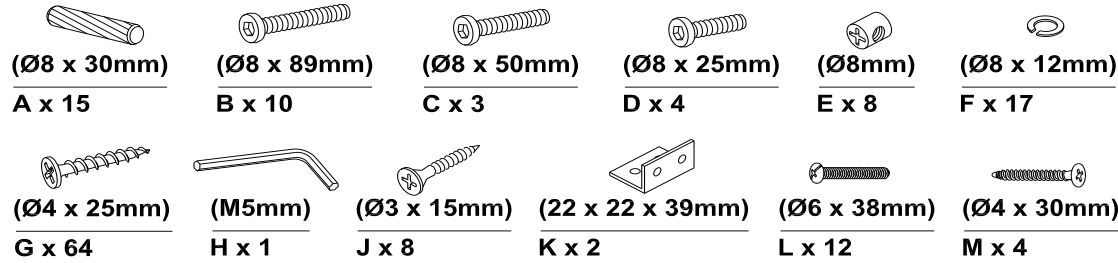

## PARTS

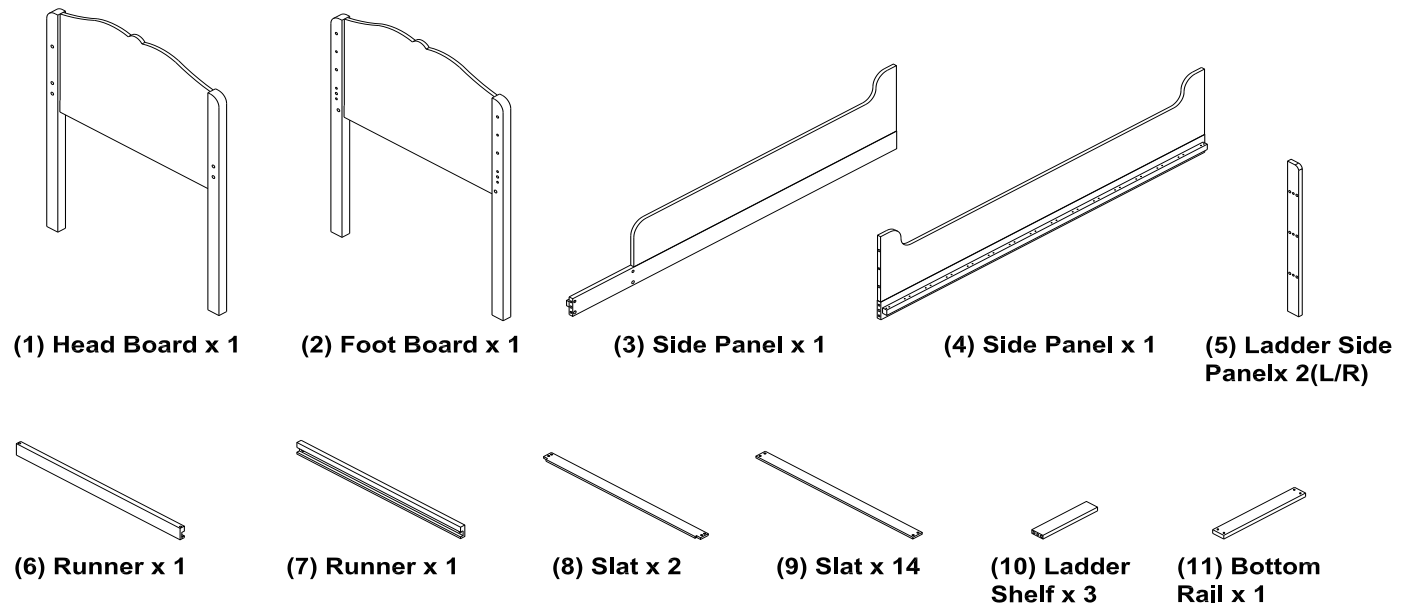

## STEP ONE

1. Attach 1 x runner 7 to foot board 2 with 2 x bolts (D) and 2 x spring washers (F) using allen key (H) and tighten.

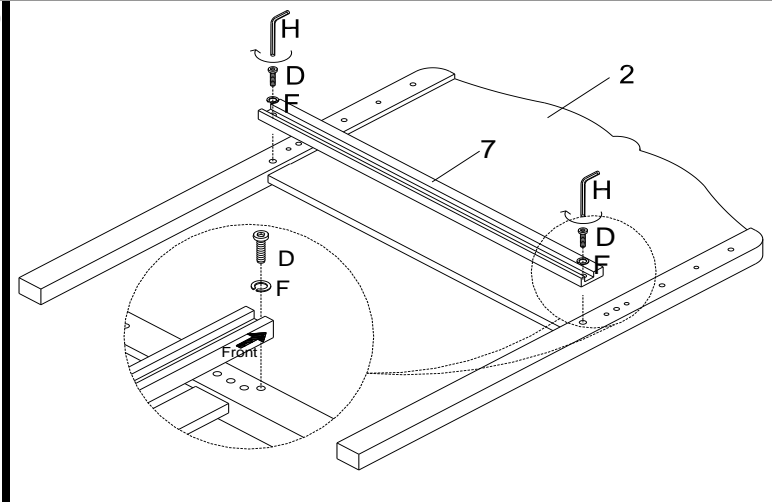

## STEP TWO

1. Insert 3 x wooden dowels (A) to ladder side panel 5-L.
2. Attach 3 x ladder shelves 10 to 1 x ladder side panel 5-L with 6 x bolts (L) and tighten with a screwdriver.

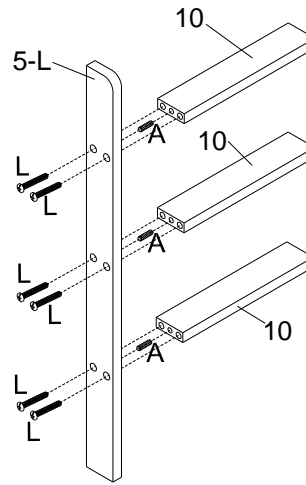

## STEP THREE

1. Insert 3 x wooden dowels (A) into ladder side panel 5-R.
2. Attach ladder side panel 5-R to the assembled unit with 6 x bolts (L) and tighten with a screwdriver.

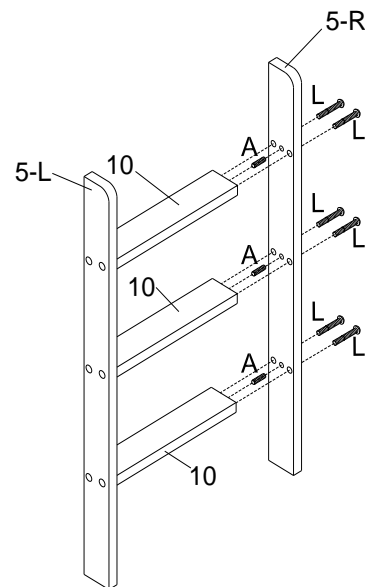

## STEP FOUR

1. Insert 3 x wooden dowels (A) into head board 1.
2. Insert 4 x barrel nuts (E) into side panel 3 and side panel 4.
3. Attach head board 1 to side panel 3 and side panel 4 with 4 x bolts (B), 1 x bolt (C) and 5 x spring washers (F) using allen key (H) and tighten.

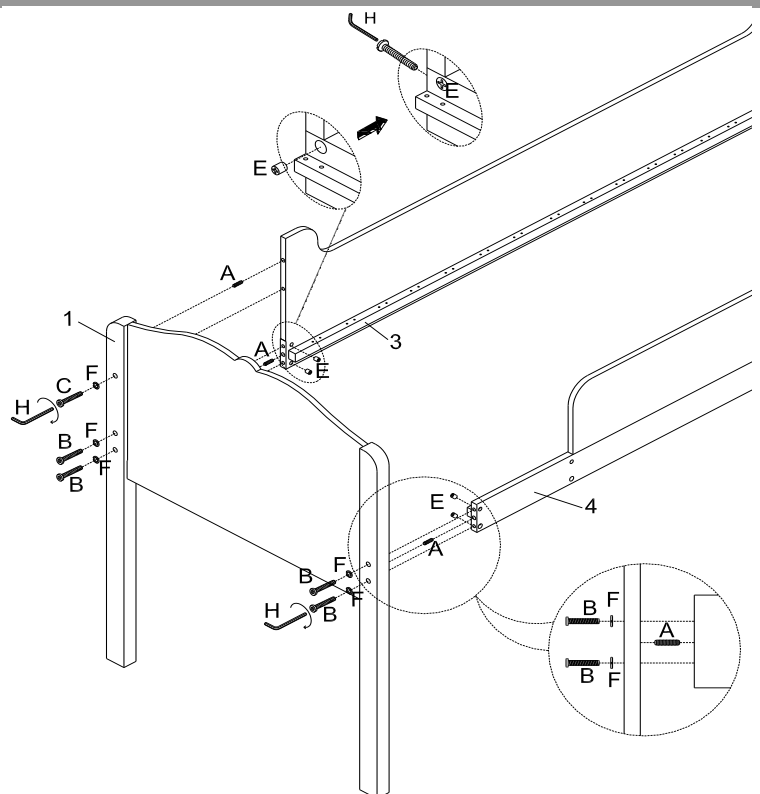

## STEP FIVE

1. Insert 4 x wooden dowels (A) into foot board 2.
2. Insert 4 x barrel nuts (E) into side panel 3 and side panel 4.
3. Attach foot board 2 to side panel 3 and side panel 4 with 4 x bolts (B), 2 x bolts (C) and 6 x spring washers (F) using allen key (H) and tighten.

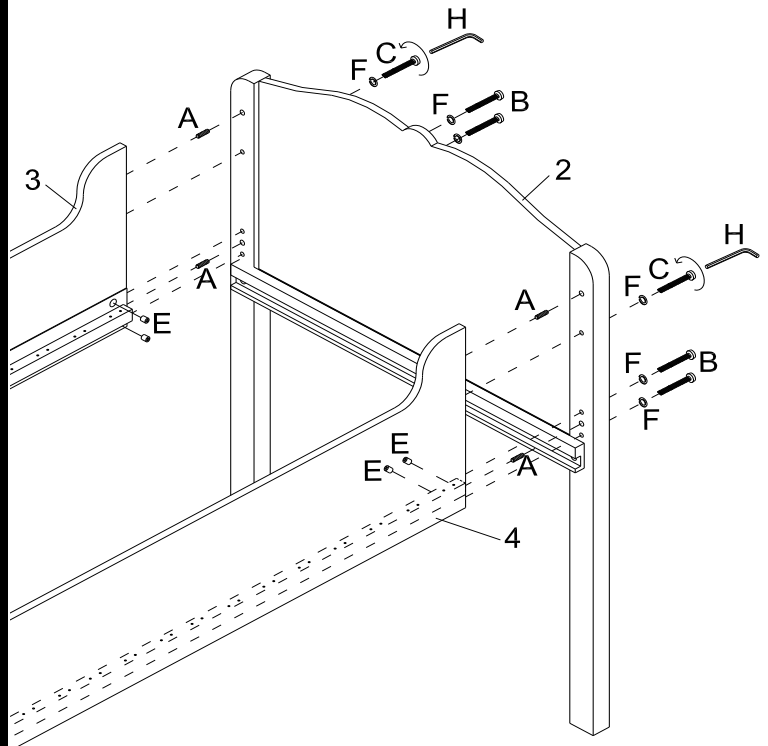

## STEP SIX

1. Insert 2 x wooden dowels (A) into side panel 4.
2. Attach ladder to side panel 4 with 2 x bolts (D) and 2 x spring washers (F) using allen key (H) and tighten.
3. Attach runner 6 to the assemble unit with 2 x bolts (B) and 2 x spring washers (F) using allen key (H) and tighten.

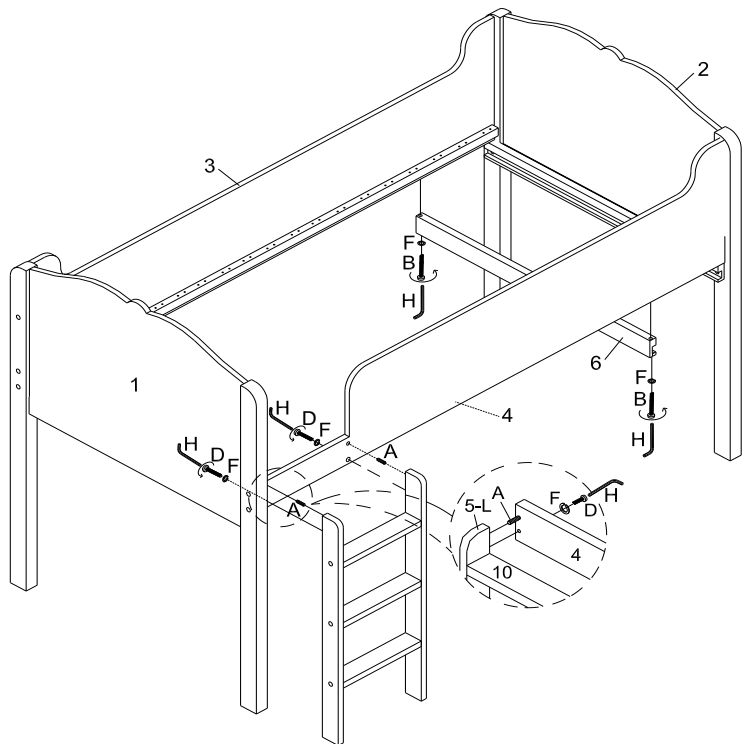

## STEP SEVEN

1. Attach 2 x slats 8 (these must be positioned at each end of the bed base) and 14 x slats 9 to the assembled unit with 64 x screws (G) and tighten with a screwdriver.

2. Attach ladder to head board 1 with 2 x "L" metal brackets (K) and 8 x screws (J).

The mark on the bed shows the maximum mattress height position, when putting on the mattress, it should not be higher than this groove.

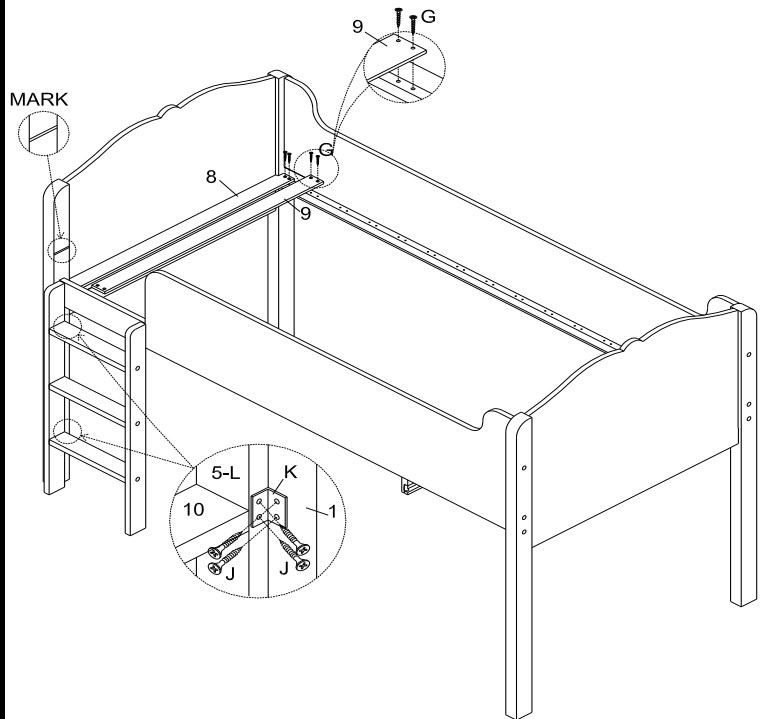

## STEP EIGHT

1. Attach bottom rail (11) to wooden runner 6 and 7 with 4 x screws (M) and tighten with screwdriver.

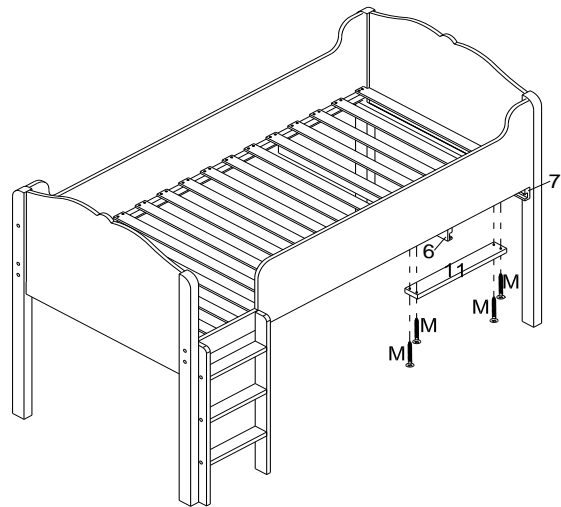

## STEP NINE

Position as shown

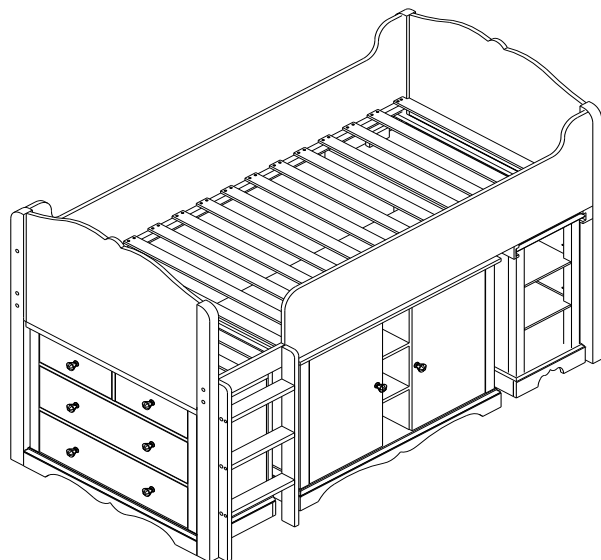

# PACKAGING LAYOUT

